

Pinch Hitter Bat Adapters



The Pinch Hitter is a terminal device for holding a bat, and comes in three models. They are constructed with high-performance, flexible synthetic rubber, which can be snapped on and off aluminium bat handles safely.

They transfer body power and energy, which the device stores and then releases to help improve swing speed and hitting power.

Part Number	Model
NPINCHITTER	Pinch Hitter
NPINCHITTER-HD	Pinch Hitter HD
NPINCHITTER-FLEX	Pinch Hitter Flex

Technical Information

Model	Pinch Hitter	Pinch Hitter HD	Pinch Hitter Flex
Length	11cm	13cm	16.5cm
Width	3.8cm	3.8cm	3.8cm
Weight	114g	142g	227g
Materials	Proprietary flexible polymer rubber		

Features

- Can be screwed into standard prosthetic wrists or disconnect-style wrist adapters
- Needs to be 'over-gripped' with the second hand when swinging a bat
- ½" x 20TPI (M12 available, order conversion part number: NCUSTM)

Application

- Can be used either right or left handed, but performs best on leading arm
- Pinch Hitter - For children or users with small hand proportions, who wish to swing a bat utilising the power and function of both hands.
- Pinch Hitter Heavy Duty - For young adults, older children or adults who require a device with more performance
- Pinch Hitter Flex - For adults who play a lot of baseball/softball, and require a flexible, replaceable coupling and may need a longer adapter

Mountain Master Mountain Bike



The Mountain Master Mountain Bike terminal device provides the user with excellent stability and secure control on their handlebars. It features a stainless steel ball-pedestal mount with machined aluminium mounting hub, and a flexible, strong polyurethane body with a shock-absorbing design. The quick connect and release system means the terminal device is not locked to handlebars providing improved control for the rider.

Part Number
NMTNMASTER-█

█ = Colour (Black = leave blank, G = Green)

Technical Information

Length	10.7cm
Width	6.1cm
Height	8.4cm
Weight	270g



Features

- Passive contoured features provide bike frame carrying capability
- Fits all standard 7/8" (2.2cm) diameter bars
- Snap-on and lift-off function
- ½" x 20TPI (M12 available, order conversion part number: NCUSTM)

Criterion Bicycle Handlebar Adapters

Both adult models, the Criterion and Criterion Pivot, provide an offset centreline duplicating the normal palm grasping position for improved bio-mechanics when cycling.

The Criterion is the original version, which has softer, more flexible properties providing easier application.

The Pivot version is made up of two pieces, allowing for much greater angulation and arm torque. The adjustable friction pivot mechanism results in higher performance, yet is more difficult to release from the bars.

The Criterion Pivot Short is for children and has a wedge design. It features integral radial, and an ulnar pivoting action that provides greater versatility, control and safety for the rider.



Criterion & Criterion Pivot



Criterion Pivot Short

Features

- Handlebars can be taped with material to change friction and force required to engage/disengage the Kriteriums
- All models snap/pull on and off 1" (2.54cm) diameter bicycle handlebars and fit right or left
- ½" x 20TPI (M12 available, order conversion part number: NCUSTM)
- Has multiple uses - see crossover table on p.32

Application

- 70 durometer is recommended for children and less aggressive riders. Load required to directly release is approx. half that of the 85 durometer
- 85 durometer is recommended for more aggressive riders
- The Criterion Pivot Short model is for children aged three years and older, and it is recommended that older children use the Firm version

Part Number	Model
NCRITERIUM-70	Criterion
NPIVOT-85	Criterion Pivot 85 (Firm)
NPIVOT-SHORT-70	Criterion Pivot Short (Soft)
NPIVOT-SHORT-85	Criterion Pivot Short (Firm)

Technical Information

Model	Criterion	Criterion Pivot	Criterion Pivot Short
Length	8.6cm	10.2cm	7.4cm
Width	6.4cm	6.4cm	6.1cm
Weight	184g	213g	170g
Colour	Black	Black/Satin	Black/Satin

Ener-Joint

Compact and self-contained, the Ener-Joint is designed to be mounted to mimic the centre of the anatomical elbow. The rapid and reliable bicycle hub-style locking lever provides a quick release mechanism, providing enhanced control for the user. Elastomeric energy storing and release allows this elbow to provide progressive resistance throughout flexion/extension, whilst the energy absorbing isolation module provides constant shock absorption.

Designed for adult-grade rugged activities, the Ener-Joint is particularly suitable for the following activities: mountain biking, ATV riding, off-road motorcycle riding, rowing, and kayaking.

Part Number
NENER-JOINT*

Technical Information

Cylinder Diameter	7.6cm
Cylinder Width	3.8cm
Module Overall Length	9.7cm
Module Overall Width	9.9cm
Weight	540g
Colour	Stainless steel & black aluminium

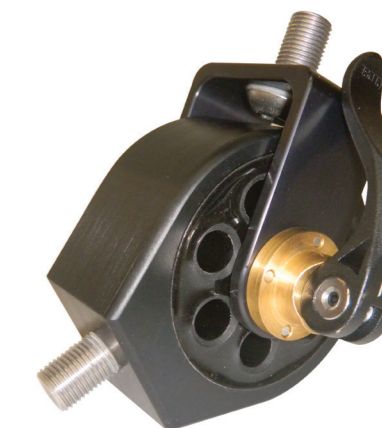

Features

- ½" x 20TPI for proximal and distal connection (M12 available, order conversion part number: NCUSTM)
- Endoskeletal design
- Custom attachment couplings are available
- Polyurethane core isolates external shock forces under both flexion and extension
- Variety of pre-positionable, lockable angular orientations

Application

- For adults undertaking rugged activities and loads, but can be used by active young adults

*Please contact customer services or visit www.steepergroup.com to download and complete a separate Ener-Joint Order Form